

NEW RS CONCRETE BLOCK WALL ASSEMBLY
(WALL TYPE #1) PER DETAIL DWG. A4-3.1
BY OTHERS.

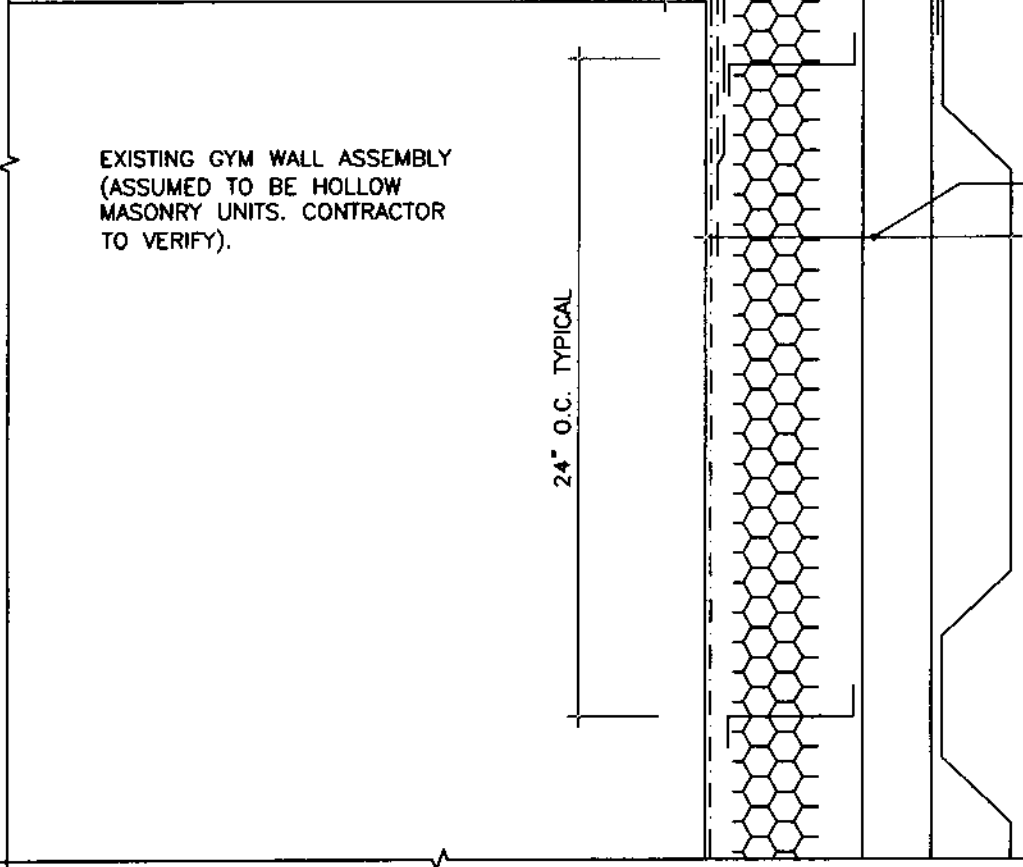
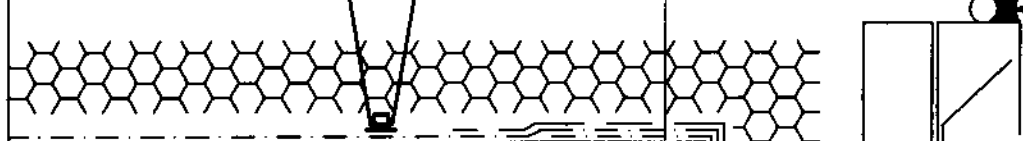
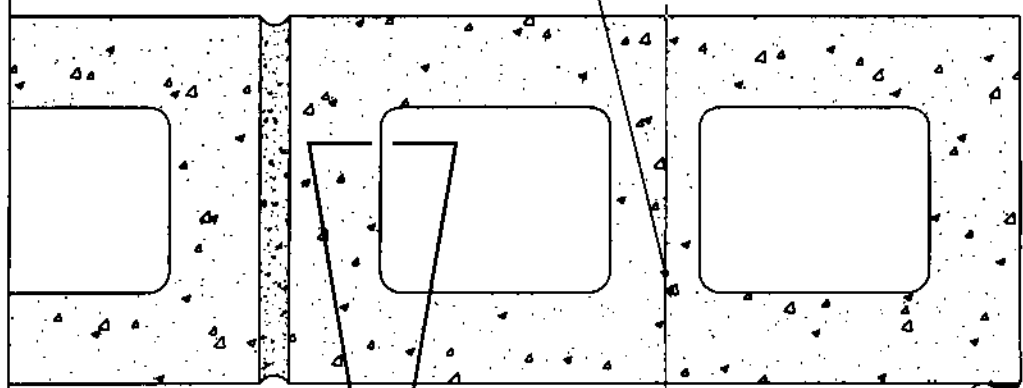

3/8" ROD AND
CAULK BY OTHERS

EXTERIOR

EXISTING GYM WALL ASSEMBLY
(ASSUMED TO BE HOLLOW
MASONRY UNITS. CONTRACTOR
TO VERIFY).

24" O.C. TYPICAL

NEW RAINSCREEN METAL
WALL ASSEMBLY AT GYM
WALL:

- 22 GA. PREFINISHED METAL CLADDING FASTENED WITH #14-7/8" SELF TAPPING SCREWS AT EACH HORIZONTAL.
- 18 GA. 1" HORIZONTAL Z-BAR FASTENED WITH #10-16x5/8" SELF TAPPING SCREWS @ 48" O.C.
- 1" AIRSPACE C/W 18 GA. 4" VERTICAL 'Z' BARS @ 24" O.C. FASTENED TO WALL WITH 1/4" x 1 3/4" KWIKCON OR TAPCON FASTENERS @ 24" O.C.
- 3" EXPAND CLOSED CELL FOAM INSULATION BY OTHERS
- EXISTING GYM WALL ASSEMBLY

EXTERNAL CORNER - PLAN VIEW

SCALE: 1 1/2" = 1'-0"